

KEEP IT  
WORKING  
SMOOTHLY

GENUINE SPARE PART KITS FOR

# Incinerators

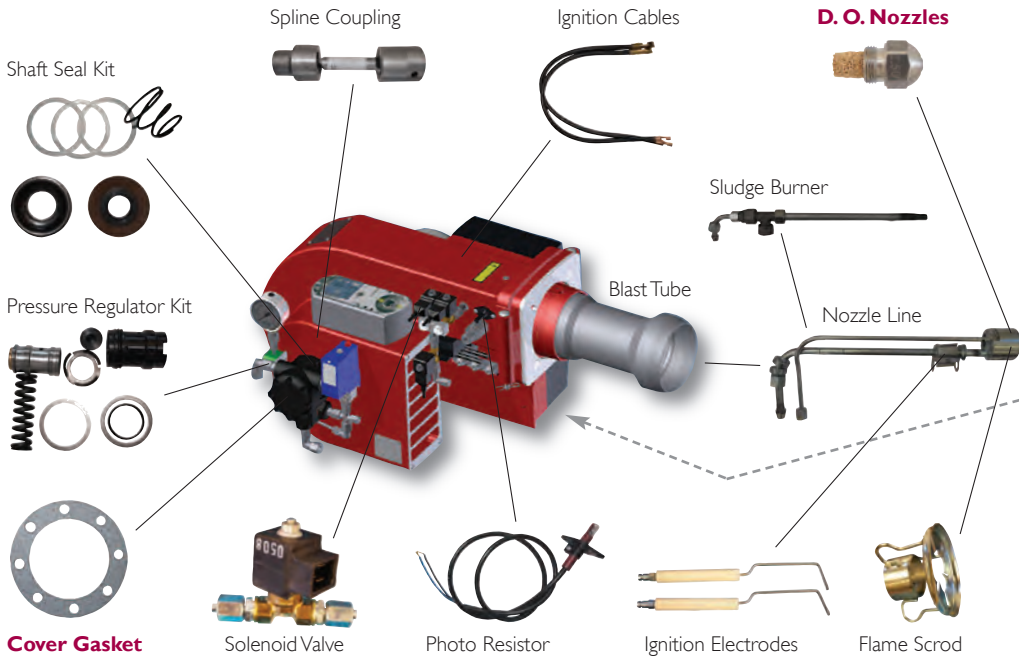

**RED TEXT: One year wear and tear parts.**

Restriction Ring



Thermocouple "N"



**Door Gasket**



Repair Material



Shaft Bearings



Thermocouple "K"

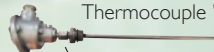

**V-Belts**

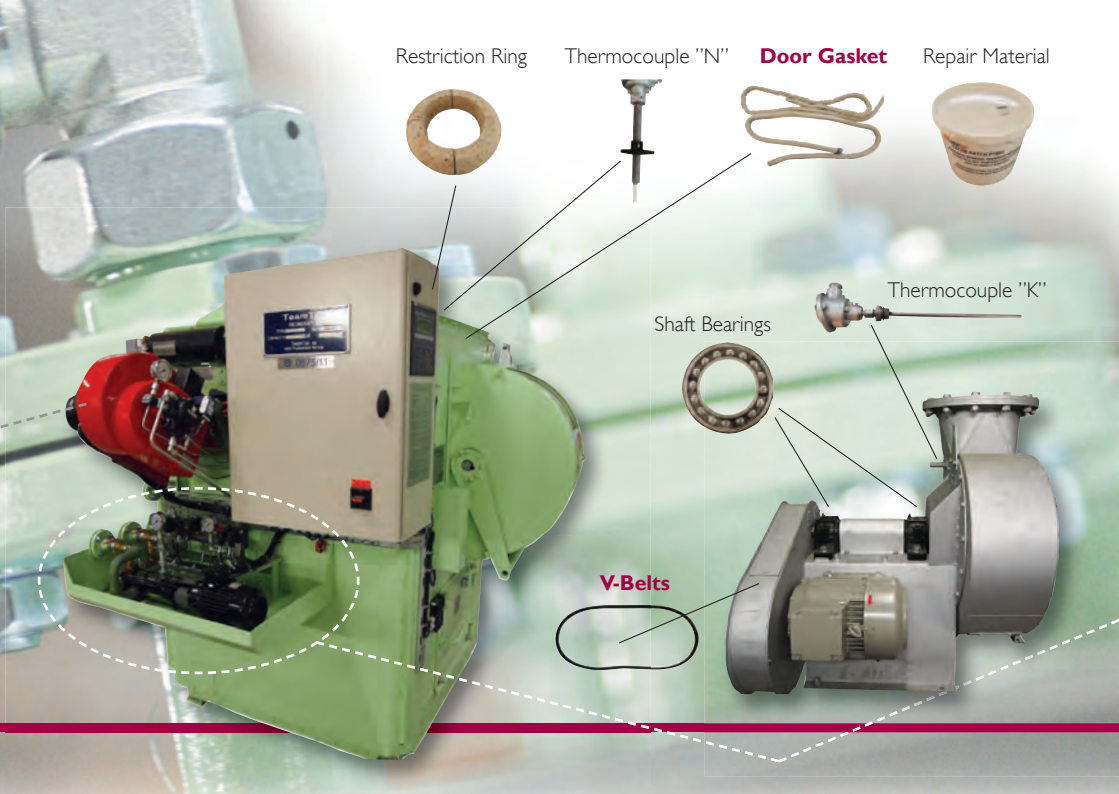

Solenoid Valve 3-way



Solenoid Valve



Thermocouple



Stuffing Box Gasket

**Stuffing Box Gasket**



Repair Kit



Mechanical Seal

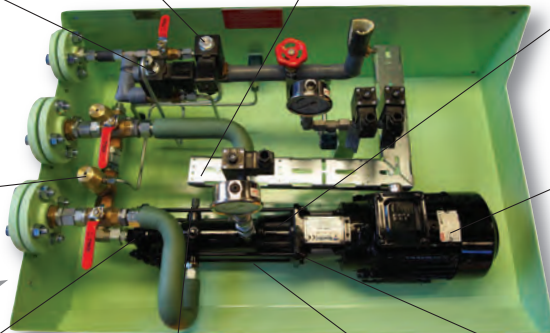

**Bounded Stator**



**Rotor**



**Universal Joint**



Seal Plate Gasket



**BLACK TEXT:** Recommended on board repair parts.

## ► One year wear and tear parts, general list

### SPARES FOR BURNER ASSEMBLY

Nozzle I

Nozzle II

Cover Gasket

### SPARES FOR SLUDGE DOSAGE ASSEMBLY

Bonded Stator

Rotor

Universal Joint

Stuffing Box Gasket

### SPARES FOR COMBUSTION CHAMBER ASSEMBLY

Glassfibre Rope (Door Gasket)

Sealing Compound (Glue For Door Gasket)

### SPARES FOR FLUE GAS FAN ASSEMBLY

V-Belts

*The exact content is depending on model and production year.*

**Our experience** over decades, with many thousands of equipment users, have resulted in what we present here. We know what the user needs, so the two new kits are reduced to the most important parts.

**All parts** that should be changed during one year operation, are assembled in a **wear and tear parts kit**. These kits will be consumed regularly with normal preventive maintenance.

**The Recommended on board repair parts kit** should be on board at any given time for unforeseen events, to make everyday life easier in terms of incineration. If the wear and tear parts are also changed regularly, most reasons for longer downtime can be avoided. Of course, this kit does not cover all situations, but it does address the most essential. Consumed parts should be replaced with new, to always have the recommended level of preparedness.

## ► Recommended on board repair parts, general list

### SPARES FOR BURNER ASSEMBLY

Flame Scrod

Blast Tube

Ignition Cables

Nozzle Line

Sludge Burner Assembly

Pressure Regulator Kit

Photo Resistor

Ignition Electrodes

Solenoid Valve

Spline Coupling Compl.

Shaft Seal Kit

### SPARES FOR SLUDGE DOSAGE ASSEMBLY

Repair Kit For Sludge Valve

Solenoid Valve I, Atomizing

Solenoid Valve II, Atomizing

Seal Plate Gasket

Mechanical Seal

Stuffing Box Gasket

Thermocouple With Pocket

### SPARES FOR COMBUSTION CHAMBER ASSEMBLY

Repair Substance For Refractory

Thermocouple

### SPARES FOR FLUE GAS FAN ASSEMBLY

Flue Gas Restriction Ring Bricks

Thermocouple

Shaft Bearings

*The exact content is depending on model and production year.*

 **TeamTec**  
MARINE PRODUCTS

**TEAMTEC AS** [www.teamtec.no](http://www.teamtec.no)  
P.O. Box 203, N-4902 Tvedestrand, Norway  
Tel. + 47 37 19 98 00, [spares@teamtec.no](mailto:spares@teamtec.no)